



Document Solutions

> PRINT > COPY > SCAN > FAX

ECOSYS M2040dn (3-in-1)

ECOSYS M2540dn (4-in-1)

ECOSYS M2640idw (4-in-1)

MONOCHROME MULTIFUNCTION  
PRODUCT FOR A4 FORMAT

# GENUINE MFP, WITH HIGH RELIABILITY AND PRODUCTIVITY



KYOCERA MyPanel



Mobile Print



- Speedy A4 copy/print up to 40 ppm (Mono).
- Standard 512MB RAM to perform heavy duty tasks without additional memory required.
- Support Air Print and Mopria certified.
- Convenient built-in wireless LAN interface\*.
- User friendly 4.3 inch color touch screen panel\*.
- Fast scanning up to 40/23 ipm Mono/Color.
- Standard high productive 50-sheet capacity one-path duplex scanning document processor.
- Low temperature fuser system for less power consumption.
- High printing quality with Fine 1,200 print resolution.

\*For ECOSYS M2640idw





# Born to be Extraordinary

## KYOCERA Document Solutions is Extraordinary for

- Broad Range of Multifunction Devices and Printers
- Optimized Total Cost of Ownership (TCO)
- Reliable with Long Life Drum and Parts
- New and Advanced Technology

KYOCERA Document Solutions strives to be a company that contributes to the society and demonstrates “Customer First” principle by providing customers with maximum value to increase their satisfaction. By adhering to the mission of producing document management devices that take balance between “Economy” and “Ecology”, KYOCERA Document Solutions succeeds to develop document management devices with advanced technologies which help customers to optimize office productivity and efficiency at a low total cost of ownership and, at the same time, improving environmental performance.

## Simplify Document Workflow

These highly productive monochrome multifunctionals support business workgroup of all sizes by packing power and productivity in a small footprint. They deliver flexibility, high level of functionality and advanced reliability while reducing environmental impact which make them ideal for workgroups seeking for superior performance.

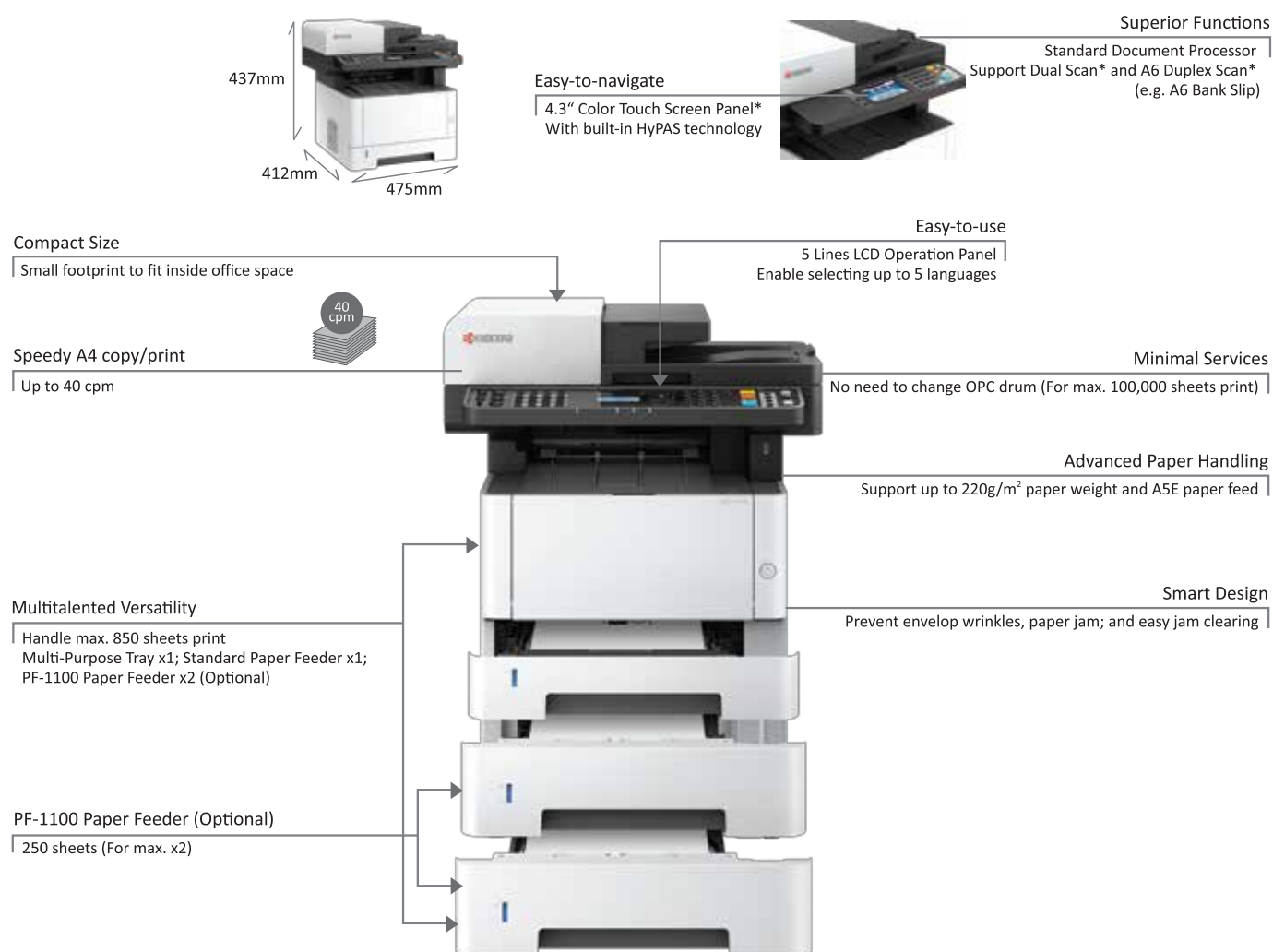



# Professional Output

## COPY/PRINT

- Convenient Multi-Purpose Tray First Mode: Allow printing via Multi-Purpose Tray whenever paper is loaded there.
- Direct print from USB memory.
- Save cost by using less paper.  
Print: Allow 25-in-1  
Copy: Allow 4-in-1
- 2-sided copy/print as standard.
- High image quality with Fine 1,200dpi printing resolution.
- Prevent envelop curling and wrinkles.
- Allow fast A5E paper path print up to 40 ppm.



## SCAN

- Support mixed size A4/Letter and Legal original in Copy/Scan.
- Skip Blank Page Function: Automatically skip blank page in copy and scan.
- Fast scanning up to 40/23 ipm in A4 Mono/Color.
- Store scanned data easily by 'Scan to FTP', 'Scan to SMB', 'Scan to Email', 'Scan to USB', 'Scan to DFS' (Distributed File System).

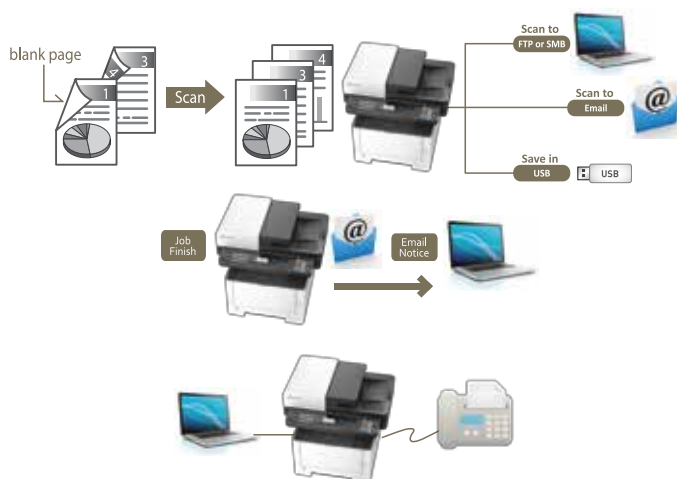

## FAX

- A destination and other transmission settings can be registered as a favor to prevent sending to wrong recipient.
- Capable of sending and receiving fax via PC with network fax function.
- Fax broadcast up to 100 different destinations.

# Impressive Security

- Authentication management among departments via IC Card.
- Sophisticated network security (SSL, IPsec) as standard and prevent improper access.
- Private Print enables secure print jobs with preset password request at the device.



# Eco-Friendly

- Low energy consumption  
Power consumption is low by using the new low temperature melting toner.  
Usage of white LED illumination for lower light emissions and power consumption.
- Free of Hazardous material  
Fulfill the requirements of **RoHS** (Restriction of Hazardous Substances) & usage of **Lead-Free Parts**.
- Reduce wastage with **Long Life Consumables and Drums**.
- Reduce noise by built-in **Quiet Mode\*\***.

# Powerful Solutions

By combining the innovative Business Applications, these MFPs can manage document in an effective approach.

- **KYOCERA MyPanel**  
Remote control designated KYOCERA printing devices by smartphone or tablet.



- **KYOCERA Net Manager\*\*\***  
Control sensitive documents and reduce printing costs.



- **KYOCERA Mobile Print**  
Conveniently print files, web pages and images using smartphone or tablet.



- **AirPrint**  
Print documents, photographs, images, etc. directly from iOS devices/Mac.



**HyPAS™**

\*Enhance device performance to meet customers' special needs (Require additional memory card).

**KYOCERA Cloud Connect**



**Teaching Assistant**



**PinPoint Scan**



\*For ECOSYS M2640idw  
\*\*Print speed will be reduced  
\*\*\*Optional



			Main Specifications		
Model			ECOSYS M2040dn	ECOSYS M2540dn	ECOSYS M2640idw
Main Function			Copy, Print, Scan, Fax (ECOSYS M2540dn/M2640idw only)		
Writing Method			Semiconductor Laser		
CPU			Cortex-A9 800 Mhz		
Print Speed (A4) (Mono)			40 ppm		
Scanning Speed (A4) 300dpi (Mono/Color)		Simplex	40/23 ipm		
		Duplex	32/16 ipm		
Memory			Standard 512MB (Max. 1,536MB)		
Warm Up Time			17 seconds		20 seconds
Paper Capacity	Standard	250 sheets (Cassette) + 100 sheets (MPT)			
	Maximum	850 sheets (Main Unit + 250 sheets PF-1100 x2 + MPT)			
Paper Size	Cassette	Min. A6R - Max. A4 (Legal)			
	Option	Min. A6R - Max. A4 (Legal)			
	MPT	Min. 70mm x 148mm - Max. A4 (Legal)			
Paper Weight	Cassette	60 - 163 g/m <sup>2</sup>			
	Option	60 - 163 g/m <sup>2</sup>			
	MPT	60 - 220 g/m <sup>2</sup>			
Duplex Printing			Paper size: A5R - A4/Legal; Paper weight: 60 - 163 g/m <sup>2</sup>		
Output Capacity			Max. 150 sheets face-down		
Control Panel			5 lines LCD (128 x 64 dot)		4.3 inch Color Touch LCD Panel
Document Processor			Standard (Max. 50 sheets one-path duplex scanning Type)		
Dimension (W x D x H) (Main Unit)			475mm x 412mm x 437mm		
Weight (Main Unit)			Approx. 19.0kg		
Power Consumption (Standard configuration)	Copy/Print Mode	661W			
	Stand-by Mode	21W			
	Energy Saver	1W			
Noise (ISO7779/ ISO9296)	Copy/Print Mode	52dB(A); Silent mode: 48dB(A)			
	Stand-by Mode	29dB(A)			
			Copy Functions (Standard)		
Copy Size			Min. A6R - Max. A4 (Legal)		
Resolution			600 x 600 dpi		
First Copy Time (Mono/Color)			6.4 seconds or less		
Zoom Ratio	Manual	25% - 400% (1% per Step)			
	Pre-defined	7R5E			
Multiple Copy			1 – 999		
			Print Functions (Standard)		
Resolution			600 x 600 dpi, Fast 1200, Fine 1200		
PDL/Emulations			PCL6 (PCL5e, PCL-XL), KPDL3 (Postscript 3 compatible), PRESCRIBE, Line Printer, IBM Proprinter X24E, Epson LQ-850, PDF Direct Print Ver. 1.7		
First Print Out Time			6.4 seconds or less		
Supported Protocol			NetBEUI, FTP, Port 9100, LPR, IPP, IPP over SSL, WSD Print, Apple Bonjour, IPsec, SNMPv3, IEEE802.1x, IPP over SSL/TLS, HTTP over SSL/TLS, FTP over SSL/TLS, SMTP over SSL/TLS, POP3 over SSL/TLS, Enhanced WSD over SSL/TLS		
Operating System Supported			Windows Server 2003, Windows Server 2008, Windows Server 2008 R2, Windows Server 2012, Windows Server 2012 R2; Windows Vista, Windows 7, Windows 8, Windows 8.1, Windows 10; Apple Macintosh OS X 10.5 or later; Linux		
Interface			USB 2.0 High Speedx1; Ethernet 10BASE-T/100BASE-TX/1,000BASE-T; USB Host Interface (USB Host)x1; 802.11 b/g/n/Wireless LAN/WiFi Direct (ECOSYS M2640idw only)		
USB Memory Printing Format			TIFF, JPEG, PDF, XPS, Open XPS		
Mobile Printing			AirPrint, Mopria, KYOCERA mobile print		
			Scan Functions (Standard)		
Color Selection			Full Color; Grayscale; Black & White		
Resolution			600dpi, 400dpi, 300dpi, 200dpi, 200x400dpi, 200x100dpi		
File Format			TIFF, JPEG, XPS, PDF (MMR/JPG/High-compression PDF), PDF/A, Encrypted PDF		
Image Type Mode			Text, Photo, Text + Photo, Light text + Fine line, OCR (mono)		
Transmission Type			Scan to SMB; Scan to E-mail ; Scan to FTP or FTP over SSL; Scan to DFS; Scan to USB; TWAIN Scan; WSD Scan, WIA		
Address Storage			200 addresses (Common address list), 50 groups (Group address list)		
			Fax Functions (ECOSYS M2540dn/M2640idw only)		
Original Size			Min. A6 - Max. A4 (Legal)		
Coding Method			MMR, MR, MH, JBIG		
Transmission Speed			33.6 kpbs		
Memory			3.5MB		
One Touch Dial		-	22 numbers		100 numbers
Network FAX			Yes		
			Consumables & Options		
Toner Kit (Page Yield in accordance with ISO/ IEC 19752)			TK-1174 (7,200 pages)		
Capacity of Start up Toner			3,600 pages		
Maintenance Kit			MK-1158 (100,000 pages)		
Paper Feeder			PF-1100: 250 sheets (Max. x2)		
Card Authentication			Card Authentication Kit(B)		



บริษัท เคียวเซรา ด็อกคิวเม้นท์ โซลูชั่นส์ (ประเทศไทย) จำกัด  
 โทร. 0-2586-0333 โทรสาร 0-2586-0278  
[www.kyoceradocumentsolutions.co.th](http://www.kyoceradocumentsolutions.co.th)

\*KYOCERA does not warrant that any specifications mentioned will be error-free. Specifications are subject to change without notice. Information is correct at time of going to press. All other brand and product names may be registered trademarks or trademarks of their respective holders and are hereby acknowledged.



KYOCERA Business Partner